

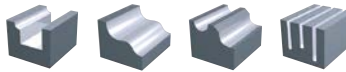

EPDRE-ATH | Epoch Deep Radius Evolution ATH

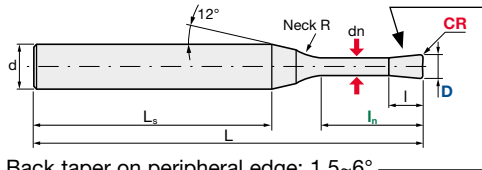

A (D0.2–D5.0)



Back taper on peripheral edge: 1.5–6°

※ Back Draft is not available for Diameters 4–6mm



Helix Angle	R Tol. [mm]	d Tol.
30°	+/- 0.005	h5

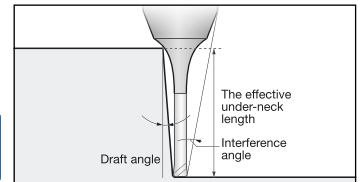

Size												Actual Effective Length in Incline angles				
ID Code	Item Code	Z	D	CR	In	I	dn	Ls	L	d	Neck R	0.5°	1°	1.5°	2°	3°
EP793	EPDRE-2002-0.5-005-ATH	2	0.2	0.05	0.5	0.15	0.17	40.56	50	4	1	0.70	0.73	0.75	0.78	0.82
EP795	EPDRE-2002-1-005-ATH				1			40.06				1.22	1.26	1.30	1.34	1.40
EP794	EPDRE-2002-1.5-005-ATH				1.5			39.56				1.74	1.79	1.84	1.89	2.06
EP796	EPDRE-2002-2-005-ATH				2			39.06				2.25	2.32	2.38	2.46	2.73
EP797	EPDRE-2003-1-005-ATH				1			40.30				1.32	1.39	1.45	1.50	1.61
EP798	EPDRE-2003-2-005-ATH				2			39.30				2.37	2.47	2.56	2.64	2.77
EP799	EPDRE-2003-3-005-ATH		3	38.30	3.41	3.54	3.65	3.74	4.05							
EP800	EPDRE-2004-1-005-ATH		1	39.59	1.32	1.39	1.45	1.50	1.61							
EP802	EPDRE-2004-2-005-ATH		2	39.53	2.37	2.47	2.56	2.64	2.77							
EP804	EPDRE-2004-3-005-ATH		3	38.53	3.41	3.54	3.65	3.74	4.05							
EP806	EPDRE-2004-4-005-ATH		4	37.53	4.45	4.60	4.72	4.86	5.38							
EP801	EPDRE-2004-1-01-ATH		1	40.53	1.31	1.38	1.44	1.50	1.60							
EP803	EPDRE-2004-2-01-ATH		2	39.53	2.37	2.47	2.55	2.63	2.77							
EP805	EPDRE-2004-3-01-ATH		3	38.53	3.41	3.54	3.64	3.74	4.04							
EP807	EPDRE-2004-4-01-ATH		4	37.53	4.45	4.60	4.72	4.85	5.37							
EP808	EPDRE-2005-1-005-ATH		1	40.77	1.32	1.39	1.45	1.50	1.61							
EP810	EPDRE-2005-2-005-ATH		2	39.77	2.37	2.47	2.56	2.64	2.77							
EP812	EPDRE-2005-3-005-ATH		3	38.77	3.41	3.54	3.65	3.74	4.05							
EP814	EPDRE-2005-4-005-ATH		4	37.77	4.45	4.60	4.72	4.86	5.38							
EP816	EPDRE-2005-5-005-ATH		5	36.77	5.49	5.66	5.79	6.05	6.71							
EP818	EPDRE-2005-6-005-ATH		6	35.77	6.53	6.71	6.91	7.25	8.04							
EP809	EPDRE-2005-1-01-ATH		1	40.77	1.31	1.38	1.44	1.50	1.60							
EP811	EPDRE-2005-2-01-ATH		2	39.77	2.37	2.47	2.55	2.63	2.77							
EP813	EPDRE-2005-3-01-ATH		3	38.77	3.41	3.54	3.64	3.74	4.04							
EP815	EPDRE-2005-4-01-ATH		4	37.77	4.45	4.60	4.72	4.85	5.37							
EP817	EPDRE-2005-5-01-ATH		5	36.77	5.49	5.66	5.79	6.04	6.69							
EP819	EPDRE-2005-6-01-ATH		6	35.77	6.52	6.71	6.90	7.24	8.02							
EP821	EPDRE-2006-2-01-ATH		2	40.00	2.53	2.69	2.82	2.95	3.17							
EP822	EPDRE-2006-4-01-ATH		4	38.00	4.65	4.88	5.06	5.23	5.51							
EP823	EPDRE-2006-6-01-ATH		6	36.00	6.76	7.03	7.25	7.44	8.02							
EP824	EPDRE-2006-8-01-ATH		8	34.00	8.85	9.16	9.41	9.63	10.67							
EP820	EPDRE-2006-10-01-ATH		10	32.00	10.92	11.27	11.55	12.03	13.33							
EP825	EPDRE-2007-4-01-ATH		4	38.24	4.65	4.88	5.06	5.23	5.51							
EP826	EPDRE-2007-6-01-ATH		6	36.24	6.76	7.03	7.25	7.44	8.02							
EP831	EPDRE-2008-2-01-ATH		2	40.47	2.53	2.69	2.82	2.95	3.17							
EP833	EPDRE-2008-4-01-ATH		4	38.47	4.65	4.88	5.06	5.23	5.51							
EP835	EPDRE-2008-6-01-ATH	6	36.47	6.76	7.03	7.25	7.44	8.02								
EP837	EPDRE-2008-8-01-ATH	8	34.47	8.85	9.16	9.41	9.63	10.67								
EP827	EPDRE-2008-10-01-ATH	10	32.47	10.92	11.27	11.55	12.03	13.33								
EP829	EPDRE-2008-12-01-ATH	12	30.47	13.00	13.38	13.75	14.42	15.98								
EP832	EPDRE-2008-2-02-ATH	2	40.47	2.53	2.68	2.81	2.93	3.15								
EP834	EPDRE-2008-4-02-ATH	4	38.47	4.65	4.87	5.05	5.21	5.50								
EP836	EPDRE-2008-6-02-ATH	6	36.47	6.75	7.02	7.24	7.43	7.99								



EPDRE-ATH | Epoch Deep Radius Evolution ATH

ID Code	Item Code	Z	Size									Actual Effective Length in Incline angles																			
			D	CR	I _n	l	dn	L _s	L	d	Neck R	0.5°	1°	1.5°	2°	3°															
EP838	EPDRE-2008-8-02-ATH	2	0.8	0.2	8	0.5	0.77	34.47	50	4	4	8.84	9.15	9.40	9.62	10.64															
EP828	EPDRE-2008-10-02-ATH				10			32.47				10.92	11.27	11.54	12.01	13.30															
EP830	EPDRE-2008-12-02-ATH				12			30.47				12.99	13.37	13.73	14.40	15.95															
EP839	EPDRE-2009-4-02-ATH		0.9	0.2	4	0.6	0.87	38.71	55			4.65	4.87	5.05	5.21	5.50															
EP840	EPDRE-2009-8-02-ATH				8			34.71				8.84	9.15	9.40	9.62	10.64															
EP1236	EPDRE-2010-2-01-ATH		1	0.1	2	0.8	0.94	40.94	50			2.64	2.78	2.90	3.01	3.23															
EP1239	EPDRE-2010-4-01-ATH				4			38.94				4.74	4.95	5.12	5.28	5.55															
EP1242	EPDRE-2010-6-01-ATH				6			36.94				6.83	7.09	7.30	7.49	8.11															
EP1245	EPDRE-2010-8-01-ATH				8			34.94				8.91	9.21	9.45	9.72	10.77															
EP841	EPDRE-2010-10-01-ATH				10			32.94				10.99	11.32	11.59	12.11	13.42															
EP1227	EPDRE-2010-12-01-ATH				12			35.94				13.06	13.42	13.83	14.50	16.08															
EP1230	EPDRE-2010-16-01-ATH				16			36.94				17.18	17.60	18.39	19.29	21.39															
EP1233	EPDRE-2010-20-01-ATH				20			32.94				21.29	21.93	22.95	24.08	26.70															
EP1237	EPDRE-2010-2-02-ATH				1			0.2				2	0.8	0.94	40.94	50	2.63	2.77	2.89	3.00	3.21										
EP1240	EPDRE-2010-4-02-ATH											4			38.94		4.74	4.94	5.11	5.27	5.54										
EP1243	EPDRE-2010-6-02-ATH											6			36.94		6.83	7.08	7.29	7.48	8.08										
EP1246	EPDRE-2010-8-02-ATH											8			34.94		8.91	9.20	9.45	9.70	10.74										
EP842	EPDRE-2010-10-02-ATH											10			32.94		10.98	11.32	11.58	12.09	13.39										
EP1228	EPDRE-2010-12-02-ATH											12			35.94		13.05	13.42	13.81	14.48	16.05										
EP1231	EPDRE-2010-16-02-ATH											16			36.94		17.18	17.59	18.38	19.27	21.35										
EP1234	EPDRE-2010-20-02-ATH											20			32.94		21.29	21.92	22.94	24.06	26.66										
EP1238	EPDRE-2010-2-03-ATH											1			0.3		2	0.8	0.94	40.94	50	2.63	2.76	2.87	2.98	3.19					
EP1241	EPDRE-2010-4-03-ATH																4			38.94		4.73	4.93	5.10	5.25	5.53					
EP1244	EPDRE-2010-6-03-ATH																6			36.94		6.82	7.07	7.28	7.47	8.05					
EP1247	EPDRE-2010-8-03-ATH																8			34.94		8.91	9.20	9.44	9.68	10.70					
EP1226	EPDRE-2010-10-03-ATH		10	32.94		10.98	11.31		11.58								12.07			13.36											
EP1229	EPDRE-2010-12-03-ATH		12	35.94		13.05	13.41		13.80								14.46			16.01											
EP1232	EPDRE-2010-16-03-ATH		16	36.94		17.17	17.59		18.36								19.25			21.32											
EP1235	EPDRE-2010-20-03-ATH		20	32.94		21.28	21.91		22.92								24.04			26.63											
EP1251	EPDRE-20125-5-02-ATH		1.25	0.2		5	1.15		1.18								38.53			50		5.81	6.03	6.22	6.39	6.79					
EP1248	EPDRE-20125-10-02-ATH					10											33.53					11.00	11.33	11.59	12.12	13.42					
EP1249	EPDRE-20125-15-02-ATH					15											33.53					16.16	16.56	17.26	18.10	20.06					
EP1250	EPDRE-20125-20-02-ATH					20											33.53					21.30	21.95	22.97	24.09	x					
EP1258	EPDRE-2015-4-02-ATH				1.5	0.2		4					1.35	1.42		540.12	50					4.79	4.98	5.15	5.30	5.57					
EP1260	EPDRE-2015-6-02-ATH							6								38.12						6.88	7.12	7.32	7.50	8.14					
EP1262	EPDRE-2015-8-02-ATH							8								36.12						8.95	9.24	9.47	9.75	10.80					
EP1252	EPDRE-2015-12-02-ATH							12								37.12						13.09	13.44	13.87	14.54	16.11					
EP1254	EPDRE-2015-15-02-ATH							15								34.12						16.18	16.58	17.29	18.13	20.09					
EP1256	EPDRE-2015-20-02-ATH							20								34.12						21.32	21.97	22.99	24.11	x					
EP1259	EPDRE-2015-4-05-ATH							1.5								0.5						4	1.35	1.42	40.12	50	4.78	4.96	5.12	5.26	5.53
EP1261	EPDRE-2015-6-05-ATH																					6			38.12		6.86	7.10	7.30	7.48	8.05
EP1263	EPDRE-2015-8-05-ATH		8	36.12			8.94		9.22			9.45			9.70			10.70													
EP1253	EPDRE-2015-12-05-ATH		12	37.12			13.08		13.43			13.83			14.48			16.01													
EP1255	EPDRE-2015-15-05-ATH		15	34.12			16.17		16.56			17.25			18.07			19.99													
EP1257	EPDRE-2015-20-05-ATH		20	34.12			21.31		21.95			22.95			24.06			x													
EP1267	EPDRE-20175-5-02-ATH		1.75	0.2	5	1.55	1.67		39.71			50	5.84	6.05	6.24		6.41	6.82													
EP1264	EPDRE-20175-10-02-ATH				10				34.71				11.02	11.34	11.61		12.15	13.45													
EP1265	EPDRE-20175-15-02-ATH				15				34.71				16.18	16.58	17.29		18.13	20.09													
EP1266	EPDRE-20175-20-02-ATH	20			34.71				21.32	21.97	22.99		24.11	x																	
EP1278	EPDRE-2020-4-02-ATH	2	0.2	4	1.7	1.92	41.30		50	4.79	4.98	5.15	5.30	5.57																	
EP1280	EPDRE-2020-6-02-ATH			6			39.30			6.88	7.12	7.32	7.50	8.14																	
EP1282	EPDRE-2020-8-02-ATH			8			37.30	8.95		9.24	9.47	9.75	10.80																		
EP1268	EPDRE-2020-12-02-ATH			12			38.30	13.09		13.44	13.87	14.54	16.11																		
EP1270	EPDRE-2020-16-02-ATH			16			34.30	17.21		17.62	18.43	19.33	x																		
EP1272	EPDRE-2020-20-02-ATH			20			35.30	21.32		21.97	22.99	24.11	x																		
EP1274	EPDRE-2020-25-02-ATH			25			35.30	26.44		27.42	28.69	x	x																		
EP1276	EPDRE-2020-30-02-ATH			30			35.30	31.55		32.87	34.40	x	x																		
EP1279	EPDRE-2020-4-05-ATH			2			0.5	4		1.7	1.92	41.30	50	4.78	4.96	5.12	5.26	5.53													
EP1281	EPDRE-2020-6-05-ATH							6				39.30		6.86	7.10	7.30	7.48	8.05													
EP1283	EPDRE-2020-8-05-ATH							8				37.30		8.94	9.22	9.45	9.70	10.70													
EP1269	EPDRE-2020-12-05-ATH							12				38.30		13.08	13.43	13.83	14.48	16.01													
EP1271	EPDRE-2020-16-05-ATH	16	34.30		17.20	17.61		18.39	19.27			x																			
EP1273	EPDRE-2020-20-05-ATH	20	35.30		21.31	21.95		22.95	24.06			x																			
EP1275	EPDRE-2020-25-05-ATH	25	35.30		26.43	27.39		28.65	x			x																			
EP1277	EPDRE-2020-30-05-ATH	30	35.30		31.54	32.84		34.36	x			x																			

D2.5-
D6



EPDRE-ATH | Epoch Deep Radius Evolution ATH

ID Code	Item Code	Z	Size							Actual Effective Length in Incline angles							
			D	CR	I _n	l	dn	L _s	L	d	Neck R	0.5°	1°	1.5°	2°	3°	
EP1284	EPDRE-2025-10-02-ATH	2	2.5	0.2	10	2	2.39	36.47	50	4	4	11.08	11.39	11.67	12.23	13.55	
EP1286	EPDRE-2025-20-02-ATH				20			36.47	60			21.36	22.05	23.07	x	x	
EP1288	EPDRE-2025-30-02-ATH				30			36.47	70			31.58	32.94	x	x	x	
EP1285	EPDRE-2025-10-05-ATH			10	36.47			50	11.07			11.37	11.63	12.17	13.45		
EP1287	EPDRE-2025-20-05-ATH			20	36.47			60	21.35			22.02	23.03	x	x		
EP1289	EPDRE-2025-30-05-ATH			30	36.47			70	31.58			32.92	x	x	x		
EP1300	EPDRE-2030-8-02-ATH		3	0.2	8	2.5	2.86	39.94	55	6		9.07	9.33	9.55	9.92	10.99	
EP1290	EPDRE-2030-12-02-ATH				12			40.94	60			13.19	13.52	14.03	14.71	16.30	
EP1292	EPDRE-2030-16-02-ATH				16			36.94	60			17.30	17.77	18.59	19.50	21.60	
EP1294	EPDRE-2030-20-02-ATH				20			37.94	65			21.40	22.13	23.15	24.28	26.91	
EP1296	EPDRE-2030-30-02-ATH				30			37.94	75			31.62	33.02	34.56	36.25	x	
EP1298	EPDRE-2030-35-02-ATH				35			37.94	80			36.83	38.47	40.26	42.23	x	
EP1301	EPDRE-2030-8-05-ATH			8	39.94	55	9.06	9.31	9.53	9.87		10.89					
EP1291	EPDRE-2030-12-05-ATH			12	40.94	60	13.18	13.51	13.99	14.65		16.20					
EP1293	EPDRE-2030-16-05-ATH			16	36.94	60	17.29	17.74	18.55	19.44		21.51					
EP1295	EPDRE-2030-20-05-ATH			20	37.94	65	21.39	22.10	23.11	24.22		26.82					
EP1297	EPDRE-2030-30-05-ATH			30	37.94	75	31.61	32.99	34.52	36.19		x					
EP1299	EPDRE-2030-35-05-ATH			35	37.94	80	36.82	38.44	40.22	42.17		x					
EP1302	EPDRE-2040-12-05-ATH			4	0.5	12	3.5	3.8	43.30	60		6	13.28	13.58	14.15	14.82	16.39
EP1304	EPDRE-2040-16-05-ATH					16			39.30				60	17.38	17.89	18.71	19.61
EP1306	EPDRE-2040-20-05-ATH					20			40.30	65			21.47	22.25	23.27	24.39	x
EP1308	EPDRE-2040-24-05-ATH				24	41.30			70	25.56			26.61	27.83	x	x	
EP1310	EPDRE-2040-30-05-ATH				30	40.30			75	31.75			33.15	34.68	x	x	
EP1312	EPDRE-2040-36-05-ATH				36	39.30			80	38.01			39.68	x	x	x	
EP1314	EPDRE-2040-45-05-ATH		45		40.30	90			47.39	49.49			x	x	x		
EP1303	EPDRE-2040-12-1-ATH		12		43.30	60			13.27	13.56			14.08	14.72	16.23		
EP1305	EPDRE-2040-16-1-ATH		16		39.30				60	17.37			17.85	18.64	19.51	x	
EP1307	EPDRE-2040-20-1-ATH		20		40.30	65			21.46	22.21			23.20	24.30	x		
EP1309	EPDRE-2040-24-1-ATH	1	24		41.30	70			25.55	26.57	27.77		29.08	x			
EP1311	EPDRE-2040-30-1-ATH		30		40.30	75			31.73	33.10	34.61		x	x			
EP1313	EPDRE-2040-36-1-ATH		36	39.30	80	37.98	39.64	x	x	x							
EP1315	EPDRE-2040-45-1-ATH	45	40.30	90	47.37	49.44	x	x	x								
EP1316	EPDRE-2050-20-05-ATH	5	0.5	20	4	4.75	42.65	65	-	21.54	22.38	x	x	x			
EP1318	EPDRE-2050-40-05-ATH			40			42.65	85		42.30	x	x	x	x			
EP1317	EPDRE-2050-20-1-ATH		20	42.65			65	21.53		22.34	x	x	x				
EP1319	EPDRE-2050-40-1-ATH	40	42.65	85	42.28	x	x	x	x								
EP1320	EPDRE-2060-18-05-ATH	6	0.5	18	5	5.7	42.00	60	-	x	x	x	x	x			
EP1322	EPDRE-2060-24-05-ATH			24			46.00	70		x	x	x	x	x			
EP1324	EPDRE-2060-36-05-ATH			36			44.00	80		x	x	x	x	x			
EP1326	EPDRE-2060-54-05-ATH		54	46.00			100	x		x	x	x	x				
EP1321	EPDRE-2060-18-1-ATH		18	42.00			60	x		x	x	x	x				
EP1323	EPDRE-2060-24-1-ATH		24	46.00			70	x		x	x	x	x				
EP1325	EPDRE-2060-36-1-ATH	36	44.00	80	x	x	x	x	x								

Cutting Conditions | Schnittwerte | Condizioni di taglio | Condiciones de Corte | Conditions de coupe | Valores de corte:

High Efficient Roughing		Page 6-11	High Precision Finishing		Page 12-17	High Efficient Roughing (Rib Applications)		Page 18-23
-------------------------	--	-----------	--------------------------	--	------------	--	--	------------