

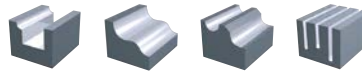

EPHPB-PN | Epoch High Precision Ball PaNacea

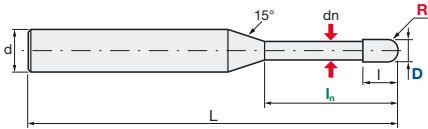

A



Carbide	PN	Rake Angle
Micro Grain	PaNacea Coating	Positive

Helix Angle	R Tol. [mm]	d Tol.
30°	+/-0.003	h4

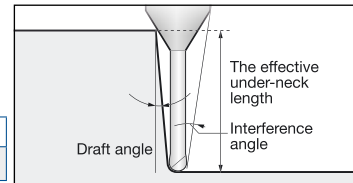

Size											Actual Effective Length in Incline angles				
ID Code	Item Code	Z	D	R	ln	l	dn	L _s	L	d	0.5°	1°	1.5°	2°	3°
EP1462	EPHPB-2001-0.2-PN	2	0.1	0.05	0.2	0.08	0.08	33.8	45	6	0.24	0.25	0.25	0.26	0.28
EP1463	EPHPB-2001-0.3-PN				0.3			33.5			0.34	0.35	0.36	0.38	0.40
EP1464	EPHPB-2001-0.5-PN				0.5			33.5			0.55	0.57	0.59	0.61	0.65
EP1465	EPHPB-2002-0.5-PN				0.5			38.6			0.57	0.58	0.60	0.62	0.66
EP1466	EPHPB-2002-1-PN		0.2	0.1	1	0.15	0.17	38.1			1.08	1.12	1.15	1.19	1.28
EP1467	EPHPB-2002-1.5-PN				1.5			37.6			1.60	1.65	1.71	1.77	1.91
EP1468	EPHPB-2003-0.5-PN		0.3	0.15	0.5	0.25	0.27	38.8			0.56	0.58	0.60	0.61	0.65
EP1469	EPHPB-2003-1-PN				1			38.3			1.08	1.11	1.15	1.19	1.27
EP1470	EPHPB-2004-1-PN				1			38.5			1.08	1.11	1.14	1.18	1.26
EP1471	EPHPB-2004-2-PN		0.4	0.2	2	0.3	0.37	37.5			2.11	2.18	2.25	2.33	2.50
EP1472	EPHPB-2004-3-PN				3			36.5			3.15	3.25	3.36	3.48	3.75
EP1473	EPHPB-2005-1-PN		0.5	0.25	1	0.35	0.47	38.7			1.08	1.11	1.14	1.17	1.25
EP1474	EPHPB-2005-2-PN				2			37.7			2.11	2.18	2.25	2.32	2.49
EP1475	EPHPB-2005-3-PN				3			36.7			3.15	3.25	3.36	3.47	3.73
EP1476	EPHPB-2005-4-PN				4			35.7			4.18	4.32	4.46	4.62	4.98
EP1477	EPHPB-2005-6-PN		0.6	0.3	6	0.4	0.57	33.7			6.25	6.46	6.68	6.92	7.46
EP1478	EPHPB-2006-2-PN	2			37.9			2.11	2.17	2.24	2.31	2.48			
EP1479	EPHPB-2006-3-PN	3			36.9			3.14	3.24	3.35	3.46	3.72			
EP1480	EPHPB-2006-4-PN	4			35.9			4.18	4.31	4.46	4.61	4.97			
EP1481	EPHPB-2006-6-PN	0.8	0.4	6	0.5	0.77	33.9	6.24	6.45	6.67	6.91	7.45			
EP1482	EPHPB-2006-8-PN			8			31.9	8.31	8.59	8.89	9.21	9.94			
EP1483	EPHPB-2008-2-PN			2			38.2	2.11	2.17	2.23	2.30	2.46			
EP1484	EPHPB-2008-4-PN			4			36.2	4.17	4.31	4.45	4.60	4.94			
EP1485	EPHPB-2008-6-PN	1	0.5	6	0.8	0.96	34.2	6.24	6.45	6.66	6.90	7.43			
EP1486	EPHPB-2008-8-PN			8			32.2	8.31	8.58	8.88	9.20	9.92			
EP1487	EPHPB-2008-10-PN			10			30.2	10.38	10.72	11.10	11.50	12.40			
EP1488	EPHPB-2010-2-PN			2			38.6	2.12	2.18	2.24	2.31	2.46			
EP1489	EPHPB-2010-4-PN	1.5	0.75	4	1.35	1.45	36.6	4.19	4.32	4.46	4.61	4.94			
EP1490	EPHPB-2010-6-PN			6			34.6	6.26	6.46	6.67	6.91	7.43			
EP1491	EPHPB-2010-8-PN			8			32.6	8.32	8.60	8.89	9.21	9.91			
EP1492	EPHPB-2010-10-PN			10			30.6	10.39	10.74	11.11	11.51	12.40			
EP1493	EPHPB-2010-12-PN	2	1	12	1.7	1.95	33.6	12.46	12.88	13.32	13.81	14.89			
EP1494	EPHPB-2015-4-PN			4			37.5	4.20	4.32	4.45	4.59	4.91			
EP1495	EPHPB-2015-8-PN			8			33.5	8.34	8.60	8.88	9.19	9.88			
EP1496	EPHPB-2015-12-PN			12			34.5	12.47	12.88	13.32	13.79	14.85			
EP1497	EPHPB-2015-16-PN	3	1.5	16	2.5	2.9	30.5	16.60	17.16	17.75	18.39	19.82			
EP1498	EPHPB-2015-20-PN			20			31.5	20.74	21.44	22.18	22.99	24.80			
EP1499	EPHPB-2020-4-PN			4			38.4	4.19	4.30	4.42	4.55	4.85			
EP1500	EPHPB-2020-6-PN			6			36.4	6.26	6.44	6.64	6.85	7.33			
EP1501	EPHPB-2020-8-PN	4	2	8	3	3.9	34.4	8.33	8.58	8.86	9.15	9.82			
EP1502	EPHPB-2020-10-PN			10			32.4	10.39	10.72	11.07	11.45	12.31			
EP1503	EPHPB-2020-12-PN			12			35.4	12.46	12.86	13.29	13.75	14.79			
EP1504	EPHPB-2020-16-PN			16			31.4	16.60	17.14	17.72	18.35	19.76			
EP1505	EPHPB-2020-20-PN	4	2	20	3	3.9	32.4	20.73	21.42	22.16	22.95	24.74			
EP1506	EPHPB-2020-25-PN			25			32.4	25.90	26.77	27.70	28.70	30.95			
EP1507	EPHPB-2030-8-PN			8			41.2	8.41	8.65	8.91	9.19	9.82			
EP1508	EPHPB-2030-12-PN			12			42.2	12.54	12.93	13.34	13.79	14.79			
EP1509	EPHPB-2030-16-PN	3	1.5	16	2.5	2.9	38.2	16.68	17.21	17.77	18.39	19.76			
EP1510	EPHPB-2030-20-PN			20			39.2	20.81	21.48	22.21	22.99	24.73			
EP1511	EPHPB-2030-25-PN			25			39.2	25.98	26.83	27.75	28.74	-			
EP1512	EPHPB-2040-10-PN			10			55	10.46	10.75	11.07	11.41	12.18			
EP1513	EPHPB-2040-20-PN	4	2	20	3	3.9	41.1	20.79	21.45	22.15	22.91	-			
EP1514	EPHPB-2040-30-PN			30			75	31.13	32.15	33.24	-	-			
EP1515	EPHPB-2040-40-PN			40			36.1	41.47	42.84	-	-	-			



EPHPR-PN | Epoch High Precision Radius PaNacea



A

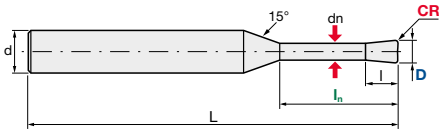

Carbide	PN	Rake Angle
Micro Grain	PaNacea Coating	Positive

Helix Angle	R Tol. [mm]	d Tol.
30°	+/-0.003	h4

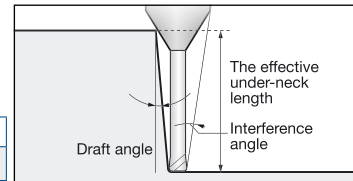

Size											Actual Effective Length in Incline angles															
ID Code	Item Code	Z	D	CR	In	l	dn	L _s	L	d	0.5°	1°	1.5°	2°	3°											
EP1516	EPHPR-2002-0.5-005-PN	2	0.2	0.05	0.5	0.15	0.17	38.6	50	6	0.57	0.59	0.61	0.63	0.67											
EP1517	EPHPR-2002-1-005-PN				1						1.08	1.12	1.16	1.20	1.30											
EP1518	EPHPR-2003-1-005-PN		0.3		0.25	0.27	38.3	37.3	38.5	37.5	1.08	1.12	1.15	1.19	1.28											
EP1519	EPHPR-2003-2-005-PN															2	2.12	2.19	2.27	2.35	2.54					
EP1520	EPHPR-2004-1-01-PN		0.4		0.3	0.37	38.5	37.5	38.7	37.7	1.08	1.12	1.15	1.19	1.28											
EP1521	EPHPR-2004-2-01-PN															2	2.12	2.19	2.26	2.34	2.53					
EP1522	EPHPR-2005-1-01-PN		0.5		0.35	0.47	38.7	37.7	37.9	36.7	2.12	2.19	2.26	2.34	2.53											
EP1523	EPHPR-2005-2-01-PN															2	3.15	3.26	3.37	3.49	3.77					
EP1524	EPHPR-2005-3-01-PN															3	2.12	2.19	2.26	2.34	2.53					
EP1525	EPHPR-2006-2-01-PN		0.6		0.4	0.57	37.9	35.9	33.9	38.2	4.18	4.33	4.48	4.64	5.01											
EP1526	EPHPR-2006-4-01-PN															4	6.25	6.47	6.70	6.94	7.50					
EP1527	EPHPR-2006-6-01-PN															6	2.12	2.19	2.26	2.34	2.53					
EP1528	EPHPR-2008-2-01-PN		0.8	0.5	0.77	38.2	36.2	34.2	36.6	4.18	4.33	4.48	4.64	5.01												
EP1529	EPHPR-2008-4-01-PN														4	6.25	6.47	6.70	6.94	7.50						
EP1530	EPHPR-2008-6-01-PN														6	2.15	2.22	2.29	2.37	2.55						
EP1531	EPHPR-2010-2-02-PN		1	0.8	0.95	36.6	34.6	32.6	30.6	10.42	10.78	11.16	11.57	12.50												
EP1532	EPHPR-2010-4-02-PN														4	12.49	12.92	13.38	13.87	14.98						
EP1533	EPHPR-2010-6-02-PN														6	4.22	4.36	4.51	4.67	5.04						
EP1534	EPHPR-2010-8-02-PN														8	6.29	6.50	6.73	6.97	7.52						
EP1535	EPHPR-2010-10-02-PN														10	8.35	8.64	8.94	9.27	10.01						
EP1536	EPHPR-2010-12-02-PN														12	10.42	10.78	11.16	11.57	12.50						
EP1537	EPHPR-2015-4-02-PN		1.5	1.35	1.45	37.5	33.5	34.5	30.5	12.49	12.92	13.38	13.87	14.98												
EP1538	EPHPR-2015-8-02-PN														8	4.22	4.36	4.51	4.67	5.04						
EP1539	EPHPR-2015-12-02-PN														12	8.35	8.64	8.94	9.27	10.01						
EP1540	EPHPR-2015-16-02-PN														16	12.49	12.92	13.38	13.87	14.98						
EP1541	EPHPR-2020-4-02-PN														2	1.7	1.95	38.4	34.4	32.4	31.4	20.76	21.47	22.24	23.07	24.93
EP1542	EPHPR-2020-8-02-PN																									
EP1543	EPHPR-2020-12-02-PN		12	12.48	12.90	13.34	13.83	14.91																		
EP1544	EPHPR-2020-16-02-PN		16	16.61	17.20	17.81	18.47	19.95																		
EP1545	EPHPR-2020-20-02-PN		20	20.75	21.45	22.21	23.03	24.86																		
EP1546	EPHPR-2020-8-05-PN		8	8.45	8.74	9.05	9.38	10.12																		
EP1547	EPHPR-2020-12-05-PN		0.5	2.5	2.9	42.2	38.2	39.2	41.2	12.59	13.02	13.48	13.98	15.10												
EP1548	EPHPR-2020-16-05-PN	12													16.72	17.30	17.91	18.58	20.07							
EP1549	EPHPR-2020-20-05-PN	16													20.85	21.57	22.35	23.18	25.04							
EP1550	EPHPR-2030-8-02-PN	8													31.19	32.27	33.43	34.68	-							
EP1551	EPHPR-2030-12-02-PN	12													8.44	8.72	9.01	9.33	10.05							
EP1552	EPHPR-2030-16-02-PN	16													12.58	13.00	13.45	13.93	15.03							
EP1553	EPHPR-2030-20-02-PN	20	16.71	17.27	17.88	18.53	20.00																			
EP1554	EPHPR-2030-30-02-PN	30	20.84	21.55	22.31	23.13	24.97																			
EP1555	EPHPR-2030-8-05-PN	0.5	3.5	3.8	42.2	38.2	39.2	41.2	12.58	13.00	13.45	13.93	15.03													
EP1556	EPHPR-2030-12-05-PN													12	16.71	17.27	17.88	18.53	20.00							
EP1557	EPHPR-2030-16-05-PN													16	20.84	21.55	22.31	23.13	24.97							
EP1558	EPHPR-2030-20-05-PN													20	31.18	32.25	33.40	34.63	-							
EP1559	EPHPR-2030-30-05-PN													30	12.77	13.20	13.65	14.15	15.26							
EP1560	EPHPR-2040-12-05-PN													12	25.17	26.03	26.95	27.95	-							
EP1561	EPHPR-2040-24-05-PN	24	37.58	38.87	-	-	-																			
EP1562	EPHPR-2040-36-05-PN	36																								

Cutting Conditions | Schnittwerte | Condizioni di taglio | Condiciones de Corte | Conditions de coupe | Valores de corte:

EPHPB Finishing		Page 4-5	EPHPR Finishing		Page 6-7
-----------------	--	----------	-----------------	--	----------