

Indexable Milling Tools

ASRM | Pico Maxi – Turbo Metric Series – Modular Type

<b>Q max</b> High Efficient	<b>Jet</b> Air Hole	<b>▽</b> Roughing	<b>▽▽</b> Semi-Finishing	<b>HRC</b> 62	<b>No. of Teeth</b> 2~6
--------------------------------	------------------------	----------------------	-----------------------------	------------------	----------------------------

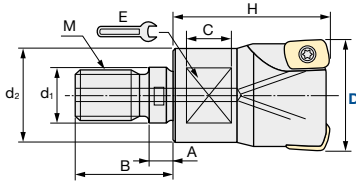
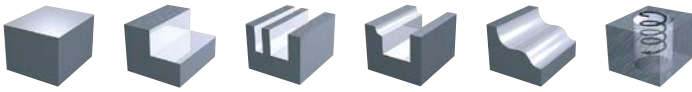

Tolerance Dia.:	CAM Radius:	Torque on screw:
<b>-0.1/-0.2</b>	<b>3 mm</b>	<b>2.0 Nm</b>

Modular Type													Inserts
ID Code	Item Code	Flutes	D	H	d <sub>1</sub>	M	d <sub>2</sub>	A	B	C	E		
FH180	ASRM-3020R-2-M10	2	20	30	10.5	M10	18	5.5	19	10	15	EPNW08T3TN-10 EPMT08T3TN-10	
FH181	ASRM-3025R-3-M12	3	25	35	12.5	M12	21	5.5	22	10	17		
FH173	ASRM-3032R-4-M16	4	32	40	17	M16	29	6	23	12	22		
FH174	ASRM-3035R-4-M16		35										
FH175	ASRM-3042R-6-M16	6	42										

Wrench Size

ASC | Carbide Shanks for Modular Mills & AS | Steel Shanks for Modular Mills: page 8

ASRB | Pico Maxi – Turbo Metric Series – Bore Type

<b>Q max</b> High Efficient	<b>Jet</b> Air Hole	<b>▽</b> Roughing	<b>▽▽</b> Semi-Finishing	<b>HRC</b> 62	<b>No. of Teeth</b> 6~10
--------------------------------	------------------------	----------------------	-----------------------------	------------------	-----------------------------

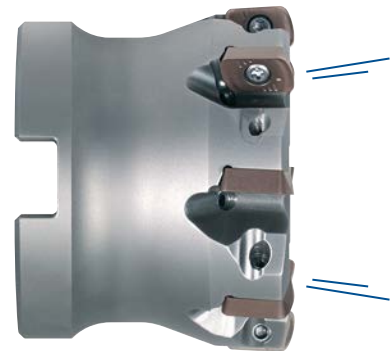
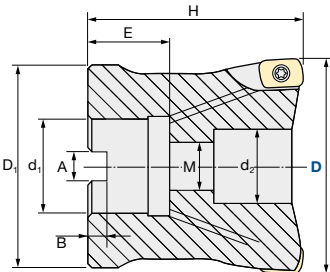
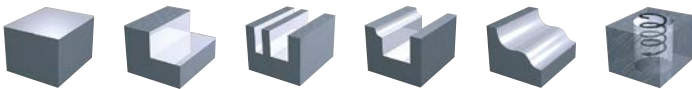

Tolerance Dia.:	CAM Radius:	Torque on screw:
<b>-0.1/-0.2</b>	<b>3 mm</b>	<b>2.0 Nm</b>

Bore Type													Inserts
ID Code	Item Code	Flutes	D	H	d <sub>1</sub>	d <sub>2</sub>	M	D <sub>1</sub>	A	B	E		
FH167	ASRB-3042RM-6-16	6	42	40	16	13.5	8	35	8.4	5.6	19	EPNW08T3TN-10 EPMT08T3TN-10	
FH274	ASRB-3050RM-7-22	7	50	50	22	17	10	40	10.4	6.3	20		
FH168	ASRB-3052RM-7-22		52										
FH169	ASRB-3052RM-7-27	8	63	70	27	20	12	60	12.4	7	22		
FH275	ASRB-3063RM-8-27												66
FH170	ASRB-3066RM-8-27	9	80	70	32	26	16	70	14.4	8	25.5		
FH171	ASRB-3080RM-9-27												66
FH172	ASRB-3100RM-10-32	10	100										

For more Details about ASR Pico and EPNW06...-8 Inserts please see our brochure No. 320.5 ASR Pico

Mehr Details über ASR Pico und EPNW06...-8 Schneidplatten finden Sie in unserer Broschüre No. 320.5 ASR Pico

Per maggiori dettagli relative a ASR Pico ed inserti EPNW06...-8 fare riferimento al nostro catalogo No. 320.5 ASR Pico

Para una información más detallada acerca del ASR Pico y las placas EPNW06...-8 ver nuestro catálogo ASR Pico No. 320.5

Pour plus de détails concernant notre ASR Pico et les EPNW06...-8 référez-vous à notre brochure N° 320.5 ASR Pico

Para mais detalhes sobre a ASR Pico e plaquetas EPNW06...-8 consulte nosso folheto N° 320.5 ASR Pico



**Indexable Milling Tools**

**INSERTS ASRM/ASRB | Pico Maxi – Turbo Metric Series – Modular/Bore Type**

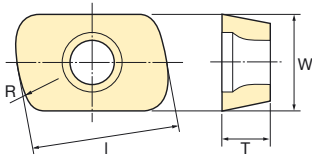

Fig.1: EPNW Standard Shape

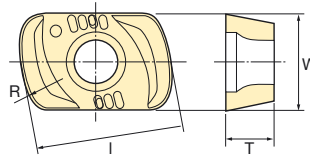
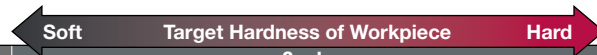
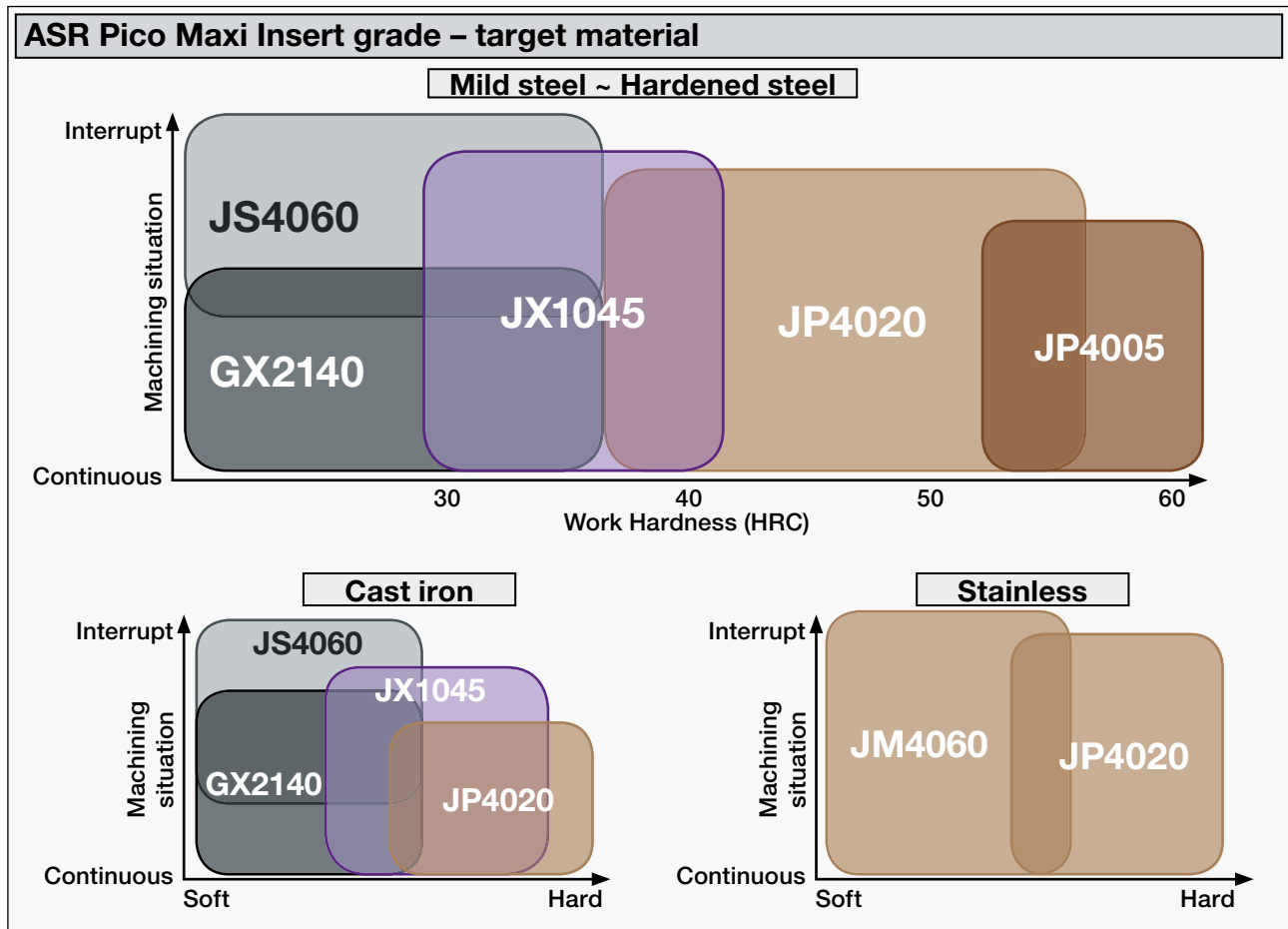

Fig.2: EPMT with Breaker



Inserts	Tolerance Class	Grade					Size (mm)				Shape	
		GX2140	JM4060	JS4060	JX1045	JP4020	JP4005	R	I	T		W
EPNW-08T3TN-10	N	WF243		WF204	WF205 ✗	WF203	WF342	10	12.648	3.97	8.25	Fig.1
EPMT-08T3TN-10	M	WF242	WF343	WF201	WF202 ✗	WF200						Fig.2

- GX2140** CVD · For heavy roughing of mild steels | Recommended for dry cutting
- JM4060** PVD · For stainless steels
- JS4060** PVD · General grade for 30 – 40 HRC | Recommended for dry cutting
- JX1045** ✗ to be replaced by JS4045
- JP4020** PVD · For pre-hardened steels 40 – 55 HRC
- JP4005** PVD · For hardened steels > 50 HRC



Type	Cutter body	Parts	Clamp Screw		Wrench	
		Shape	ID-Code	Item-Code	ID-Code	Item-Code
Modular	ASRM-3020R-2-M10 – ASRM-3042R-6-M16		ET152	265-141	ET011	104-T10
Bore Type	ASRB-3042RM-6-16 – ASRB-3100RM-10-32					

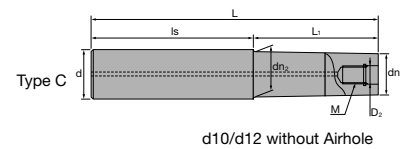
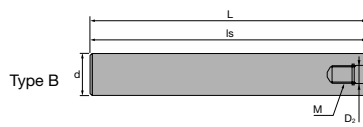
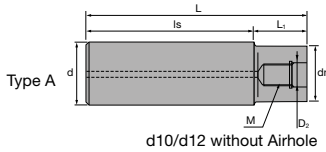

d10/d12 without Airhole

d10/d12 without Airhole

ASC | Carbide Shanks for Modular Mills



Carbide Shank		D <sub>2</sub>	M	L	L <sub>1</sub>	Is	dn	dn <sub>2</sub>	d	Type					
Without Airhole	FH137	ASC10-6.5-74-24	6.5	M6	74	24	50	9.3	-	10	A				
	FH254	ASC10-6.5-84-34			84	34									
	FH255	ASC10-6.5-114-24			114	24									
	FH138	ASC10-6.5-114-49			114	49	65								
	FH139	ASC12-6.5-74-24			74	24									
	FH256	ASC12-6.5-94-44			94	44	50					11	11.5	12	C
	FH257	ASC12-6.5-129-24			129	24									
	FH140	ASC12-6.5-129-64			129	64	65								
With Airhole	FH141	ASC16-8.5-95-30	8.5	M8	95	30	65	14.5	15.5	16	C				
	FH258	ASC16-8.5-120-55			120	55									
	FH142	ASC16-8.5-140-75			140	75									
	FH260	ASC16-8.5-160-30			160	30									
	FH259	ASC16-8.5-160-95	160	95	65										
	FH143	ASC20-10.5-120-50	10.5	M10	120	50	70	18	-	20	A				
	FH261	ASC20-10.5-170-90Z			170	90	80	18.5	19.5		C				
	FH144	ASC20-10.5-220-50			220	50	170	18	-		A				
	FH262	ASC20-10.5-220-120Z			220	120	100	18.5	19.5		20	C			
	FH263	ASC20-10.5-270-150Z			270	150	120								
	FH264	ASC20-10.5-270-50Z	270	50	220										
	FH145	ASC25-12.5-145-65	12.5	M12	145	65	80	23	-	25	A				
	FH146	ASC25-12.5-265-65			265	200									
	FH265	ASC25-12.5-215-115			215	115	100								
	FH266	ASC25-12.5-265-145			265	145	120								
	FH268	ASC25-12.5-315-65			315	65	250								
	FH267	ASC25-12.5-315-195			315	195	120								
	FH147	ASC32-17-160-80	17	M16	160	80	80	28	-	32	A				
	FH269	ASC32-17-260-140			260	140	120								
	FH148	ASC32-17-310-80			310	80	230								
FH270	ASC32-17-360-240	360			240	120									

- UK SUPER Lock milling chucks or shrink-fit holders can be used.
- DE SUPER Lock Aufnahmen oder Schrumpffutter können verwendet werden.
- IT Possono essere utilizzati mandrini a forte serraggio SUPER Lock.

- ES Aptos para amarrar en portapinzas SUPER Lock.
- FR Les attachements SUPER Lock peuvent être utilisés.
- PT Cones hidráulicos de grande aperto e aperto térmico podem ser usados.

AS | Steel Shanks for Modular Mills



Steel Shank		D <sub>2</sub>	M	L	L <sub>1</sub>	Is	dn	dn <sub>2</sub>	d	Type	
Without Airhole	FH131	AS10-6.5-74-0	6.5	M6	74	-	74	-	10	B	
	FH132	AS12-6.5-84-4			84	4	80	11	-	12	A
With Airhole	FH133	AS16-8.5-95-15	8.5	M8	95	15	80	14.5	15.5	16	C
	FH134	AS20-10.5-100-20	10.5	M10	100	20		18	-	20	A
	FH271	AS25-12.5-115-35	12.5	M12	115	35		23	23	25	
	FH272	AS32-17-110-30	17	M16	110	30		28	28	32	

- UK SUPER Lock milling chucks can be used.
- DE SUPER Lock Aufnahmen können verwendet werden.
- IT Possono essere utilizzati mandrini a forte serraggio SUPER Lock.

- ES Aptos para amarrar en portapinzas SUPER Lock.
- FR Les attachements SUPER Lock peuvent être utilisés.
- PT Cones hidráulicos de grande aperto e aperto térmico podem ser usados.

- UK For further information about modular chucks please see our brochure *Indexable Modular Series No. 328.2*
- DE Weitere Informationen über modulare Werkzeugaufnahmen finden Sie in unserem Prospekt: *Indexable Modular Series No. 328.2*
- ES Para obtener más información sobre conos modulares consulte nuestro folleto *Indexable Modular Series No. 328.2*
- IT Per maggiori informazioni riguardanti la gamma dei mandrini avvitalibili consultate il catalogo *Indexable Modular Series No. 328.2*

- FR Pour de plus amples informations concernant les attachements modulaires, voyez SVP notre brochure *Indexable Modular Series No. 328.2*
- PT Para mais informações sobre Cones Modulares consulte o nosso folheto *Indexable Modular Series No. 328.2*

Always up to date: Please check our P50 QuickFinder

**P50 PRODUCTIONS50® QuickFinder** [www.mmc-hitachitool-eu.com/quickfinder](http://www.mmc-hitachitool-eu.com/quickfinder)

MMC Hitachi Tool Engineering Europe GmbH

Itterpark 12 · 40724 Hilden · Phone +49 (0) 21 03-24 82-0 · Fax +49 (0) 21 03-24 82-30  
 E-Mail [info@mmc-hitachitool-eu.com](mailto:info@mmc-hitachitool-eu.com) · Internet [www.mmc-hitachitool-eu.com](http://www.mmc-hitachitool-eu.com)  
 © 2015 by MMC Hitachi Tool Engineering Europe GmbH · 5th Edition · Printed in Germany